

FOOTPATH / CYCLEWAY PLAN

NOTES:

1. UNDERBORING OF COUNCIL'S FOOTPATHS, CYCLEWAYS AND ROADWAYS IS ALWAYS THE PREFERRED SOLUTION WHEN INSTALLING PRIVATE UTILITY SERVICES OR PUBLIC UTILITIES. WHERE UNDERBORING IS NOT PRACTICAL THEN THESE DETAILS SHALL BE OBSERVED.
2. ENSURE COUNCIL IS NOTIFIED AND APPROVAL SOUGHT UNDER SECTION 138 OF THE NSW ROADS ACT FOR ANY WORK PROPOSED IN COUNCIL'S ROAD RESERVE IE. ROAD, DRAINAGE, FOOTPATH, CYCLEWAY AND PUBLIC UTILITY WORK.
3. REFER ALSO COUNCIL'S SPECIFICATION ROAD OPENING AND RESTORATION.
4. ENSURE SITE IS KEPT SAFE AT ALL TIMES AND THAT PROVISION IS MADE FOR PEDESTRIANS AND CYCLISTS TO PASS SAFELY AROUND THE SITE AT ALL TIMES.
5. REFER ALSO SD118, 146 & 151.
6. REFER SD155 & SD157 FOR PUBLIC UTILITY ROAD RESTORATION REQUIREMENTS.

LEGEND:

- UPU UNDERGROUND PUBLIC UTILITY
- EJ EXPANSION JOINT
- CJ CONTRACTION JOINT

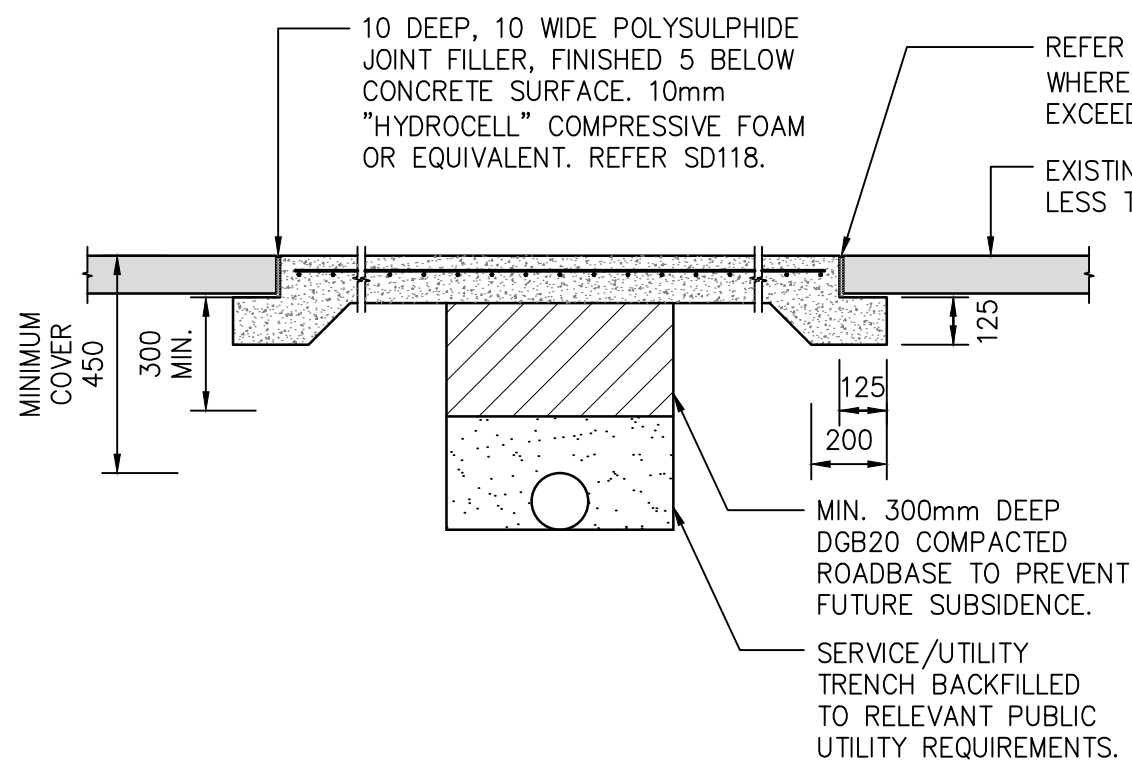

**CONCRETE RESTORATION DETAIL
(WHERE EXISTING CONCRETE THICKNESS LESS THAN 125mm)**

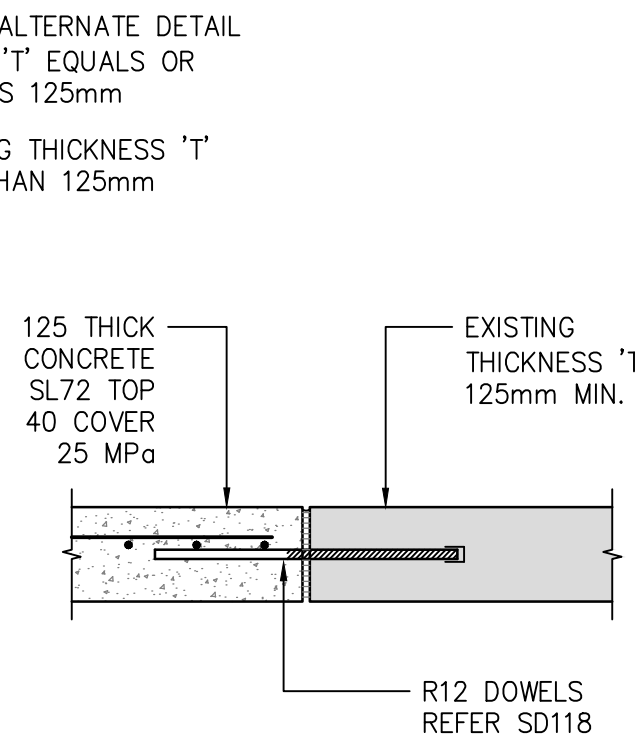

**ALTERNATE JOINT DETAIL
(WHERE EXISTING CONCRETE THICKNESS MINIMUM 125mm)**

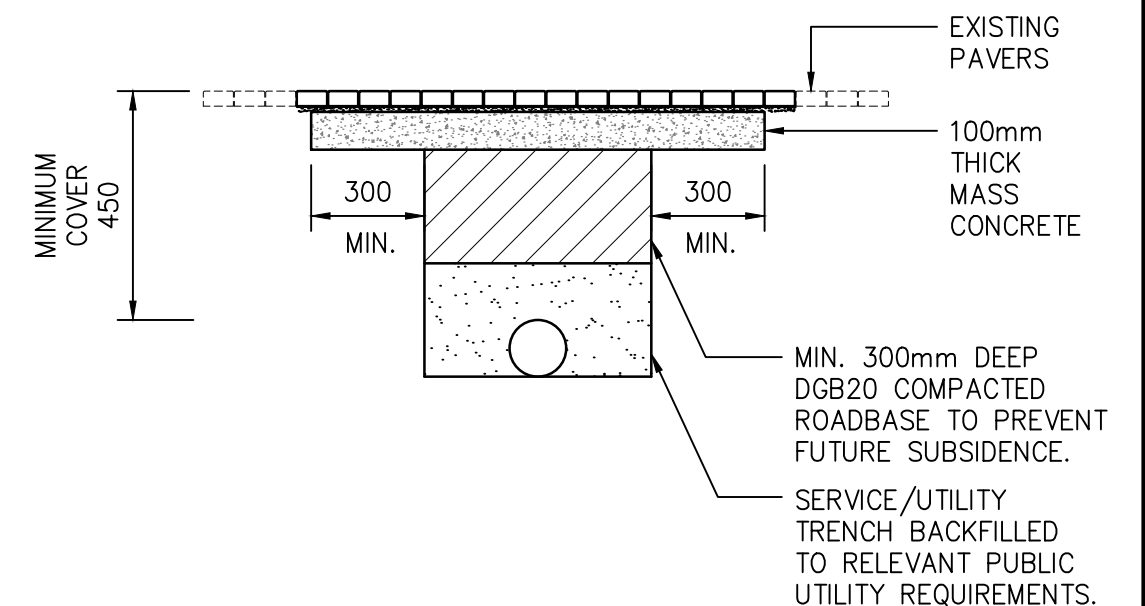

CLAY/CONCRETE PAVER RESTORATION DETAIL

A	ORIGINAL ISSUE	KSC	25/01/21
ISSUE	AMENDMENTS	DRAWN	DATE



DRAWN KSC
NOT TO
SCALE SCALE
SHEET SIZE: **A3**

APPROVED
[Signature]
GROUP MANAGER
INFRASTRUCTURE SERVICES
D.L.

WINGECARRIBEE SHIRE COUNCIL			
STANDARD DRAWING			
PUBLIC UTILITY PATH RESTORATION REQUIREMENT			
DATE: 25/01/2021	PLAN No: SD163	SHEET 1 OF 1	ISSUE A