

HRV SWEEP PATHS & SIGHT DISTANCE

1:400

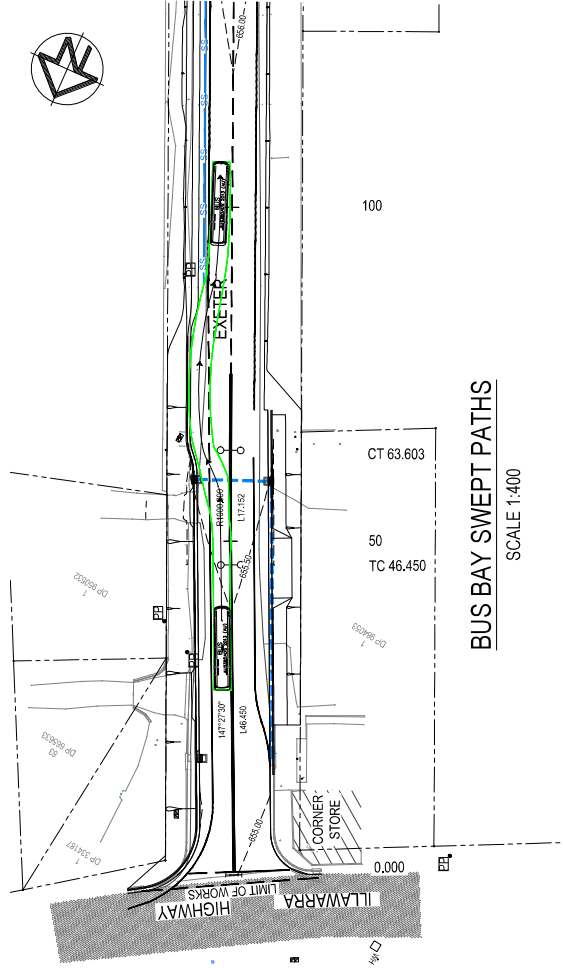

BUS BAY SWEEP PATHS

SCALE 1:400



WINGECARRIBEE SHIRE COUNCIL
 EXETER ROAD RECONSTRUCTION
 EXETER ROAD
 SUTTON FOREST NSW 2577
 SWEEP PATHS

PROJECT ID: 1.2.195
 CAD FILE/PLAN No: 2401.C108
 COST No: 40899
 ISSUE E

APPROVED
 GROUP MANAGER INFRASTRUCTURE SERVICES
 RECOMMENDED
 MANAGER DESIGN CONSTRUCTION MAINTENANCE
 NOTED
 ASSETS ENGINEER

SURVEYED
 DESIGNED
 DRAWN
 CHECKED
 SUPERVISOR

ISSUED FOR REVIEW
 ISSUED FOR 80% DETAILED DESIGN
 ISSUED FOR 100% DETAILED DESIGN
 AMENDMENTS

13.10.20
 05.02.21
 25.02.21

SCALE
 1:1000
 1:500
 1:250
 1:125

13.10.20
 05.02.21
 25.02.21

PUBLIC UTILITIES LEGEND	
SWER	ELECT TROUBLE CABINET
MANHOLE	TELEPHONE CABLE
GAS VALVE	TELEPHONE PIT
GAS METER	TELEPHONE PULL
STOP VALVE	TELEPHONE POLE
AIR VALVE	TELEPHONE CABLE MARKER
WATER TAP	POLE & TRANSFORMER
WATER	OVERHEAD ELECTRICITY
RECYCLED WATER	UNDERGROUND ELECTRICITY
HYDRANT	ELECTRICITY PIT
STOP VALVE	POWER POLE
AIR VALVE	POWER LIGHT POLE
WATER METER	LIGHT POLE
WATER TAP	STAY POLE

WINGECARRIBEE SHIRE COUNCIL
 646 Centre, Elizabeth Street, Moss Vale, N.S.W. 2577
 Ph: (02) 4881 8888 Fax: (02) 4881 2003